

\$441,900 (Includes Lot)

8

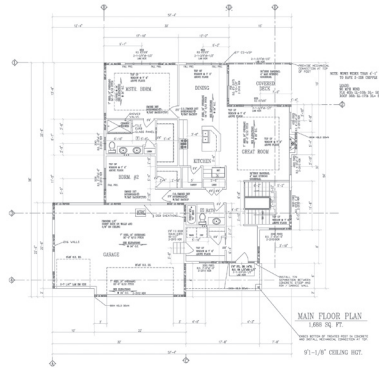

**Hart Farm
2384 Hart Dr SW, Rochester**

Finished Square Footage (Not Including Garage).....	3376
Total Square Footage (Not Including Garage).....	3376
Garage Square Footage	684
Number of Bedrooms	4
Number of Baths	3
Exterior Material	Vinyl, Stone
Home Amenities	• open floor plan • main floor living • master suite with walk-in closet

Contractor License #BC431673

A new uniquely designed model with 4 bedrooms, 3 baths, covered deck, and impressive custom features. The spacious and open layout boasts tray ceiling, gas fireplace with stone surround, quality craftsmanship with birch cabinetry and flooring, granite countertops and many other quality upgrades. Beautiful curb appeal with stone accents, three car garage and irrigation system. This home also offers main floor laundry/mudroom, large master suite, walk-in closet and master bath with gorgeous tiled shower. This rambler is a top pick. Ideally located in popular Hart Farms.

Directions: From Hwy 63 South. Take 40th St SW exit (Cnty Rd 117 SW) and go west approx. 2 miles; turn right on 18th Ave SW; left on Hart Dr SW.



Bigelow Homes
4057 - 28th St NW, Suite 100
Rochester MN 55901
(507) 529-1161 • bigelowhomes.net

This company has been a Member of Rochester Area Builders since 1984.

