

\$302,000 (Includes Lot)



**Harvestview
5664 Cornucopia Ave NW, Rochester**

Finished Square Footage (Not Including Garage).....	1404
Total Square Footage (Not Including Garage).....	1404
Garage Square Footage	660
Number of Bedrooms	2
Number of Baths	2
Exterior Material	Vinyl
Home Amenities • open floor plan • one level living • covered porch • association	

Contractor License #BC431673

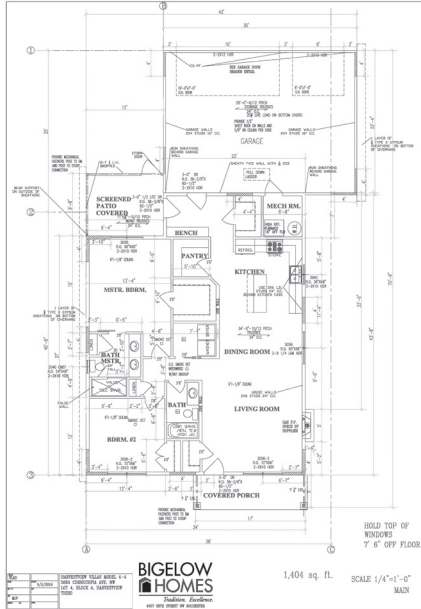

New one level villa features an open floor plan, granite surfaces, oversized mudroom with boot bench and large closet. Owner suite features a walk-in closet and ceramic bath with double vanity with custom shower. Hard to find 3 car garage and covered porch.

Directions: From Hwy 52 North. Take 55th Street exit and go west on 55th St NW; right on 50th Ave NW; left on 56th St NW; right on Harvest Moon Blvd NW.



Bigelow Homes
4057 - 28th St NW, Suite 100
Rochester MN 55901
(507) 529-1161 • bigelowhomes.net

This company has been a Member of Rochester Area Builders since 1984.

