

\$572,900 (Includes Lot)

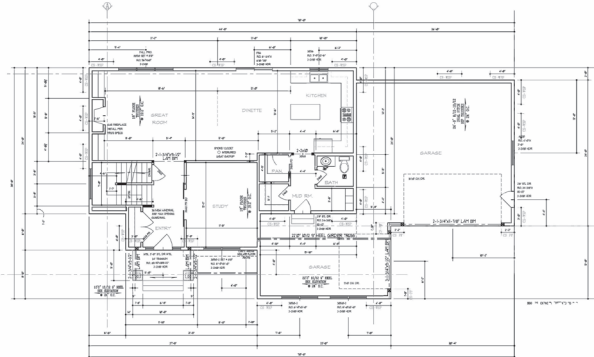

Somerby
1702 Ancaster Dr NE, Byron

New 2 story model home in Somerby. Customized detail and features throughout the home. Over 2400 sqft of finished living space with expansion room in the lower level. Granite surfaces, over-sized owner suite. Laundry located on bedroom level, built-in cabinetry and Superior Walls Foundation.

Finished Square Footage (Not Including Garage).....	2457
Total Square Footage (Not Including Garage).....	3646
Garage Square Footage	920
Number of Bedrooms	4
Number of Baths	3
Exterior Material	Fiberboard, Stone
Home Amenities • over-sized owner's suite • granite surfaces • built-in cabinets	

Directions: From Hwy 14 West. Take Hwy 14 into Byron; right on 10th Ave NE; go north for approx. 1 mile; left on Somerby Pkwy NE; right on Ancaster Dr NE. Home will be on the right.



Bigelow Homes
 4057 - 28th St NW, Suite 100
 Rochester MN 55901
 (507) 529-1161 • bigelowhomes.net

Contractor License #BC431673

This company has been a Member of Rochester Area Builders since 1984.

